

DUTCH VILLAGE

1-888-692-7086

2349 Perring Manor Road
Baltimore, MD 21234

Leasing Office

2349 Perring Manor Road
Baltimore, MD 21234
1-888-692-7086

Office Hours

Monday	09:00 AM - 06:00 PM
Tuesday	09:00 AM - 06:00 PM
Wednesday	09:00 AM - 06:00 PM
Thursday	09:00 AM - 06:00 PM
Friday	09:00 AM - 06:00 PM
Saturday	10:00 AM - 06:00 PM
Sunday	12:00 PM - 05:00 PM



Dutch Village offers townhome community living well-situated to Baltimore City and County arts, entertainment and business centers. The community is located just 3 miles South of Towson University, Towson Town Center and The Towson Court House and just 30 minutes North of Downtown Baltimore, The Maryland Science Center, Camden Yards and Ravens Stadium. Inside your townhome you will find a well equipped eat in kitchen. Your living room offers a large sliding glass door with access to your back patio. The upper level offers one, two or three bedrooms each with ample closet space and a linen closet for the main bathroom. Apartments are also available at Dutch Village featuring one and two bedroom floor plans with many of the same great amenities as the townhomes! Visit Dutch Village today to inquire about your new home! Ask about our Preferred Employer Discount Program Star Award Winner! 2008, 2009 & 2010 Stellar Community - Gold Award





Features

- Wall-to-wall carpeting:
- Eat-in kitchen:
- Central air conditioning:
- Gas heat:
- Patio:
- Private entrances:
- Large closets:
- Cable ready:

Community Amenities

- Playground:
- On-site laundry centers:
- 24-Hour emergency maintenance:

Location Amenities

- Situated next to Mt. Pleasant Golf Course:
- Shopping nearby: Towson Marketplace, White Marsh Mall, The Avenue at White Marsh, Wal-Mart, Home Depot and Lowes:
- Convenient to Baltimore's Inner Harbor, Pimlico Race Track, Maryland State Fair Grounds:
- Hospitals nearby: Johns Hopkins Hospital, GBMC, Good Samaritan and Franklin Square Hospital:
- Easy access to I-695, I-95, I-83, Northern Parkway and public transportation:
- Close to Morgan State University:
- Enjoy a variety of great local eateries:

*In selected homes

Pet Policy

Cats and dogs permitted:
Max. # of pets - 2:
\$25 monthly pet fee:
\$250 one-time pet fee:
50 lb. max. weight limit:
Pet restrictions apply:

Additional Information

Renter's insurance program available:
Online payments welcome:
Short term leases available:

One Bedroom

One Bedroom • One Bathroom Apartment

Rent: UnFurnished \$648 - \$663

Square Footage: 550 Square Deposit: \$300+ Application Fee: \$35

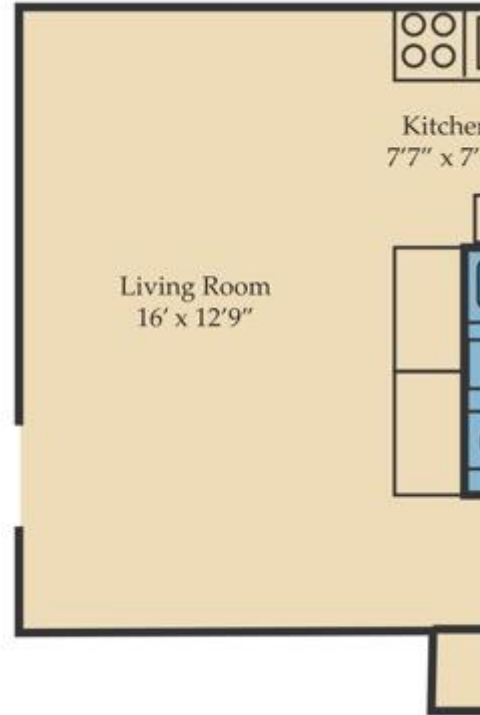

One Bedroom

One Bedroom • One Bathroom Apartment

Rent: UnFurnished \$720 - \$795

Square Footage: 606 Square Deposit: \$300+ Application Fee: \$35



Two Bedrooms

Two Bedrooms • One Bathroom Apartment

Rent: UnFurnished \$764

Square Footage: 744 Square Deposit: \$300+ Application Fee: \$35



Two Bedrooms

Two Bedrooms • One Bathroom Apartment

Rent: UnFurnished \$823 - \$898

Square Footage: 837 Square Deposit: \$300+ Application Fee: \$35



Two Bedrooms

Two Bedrooms • One Bathroom Apartment

Rent: UnFurnished \$716 - \$791

Square Footage: 783 Square Deposit: \$300+ Application Fee: \$35



FIRST FLOOR

Three Bedrooms

Three Bedrooms • One Bathroom Apartment

Rent: UnFurnished \$876 - \$967

Square Footage: 1012 Square Deposit: \$300+ Application Fee: \$35



FIRST FLOOR

SECOND FLOOR